

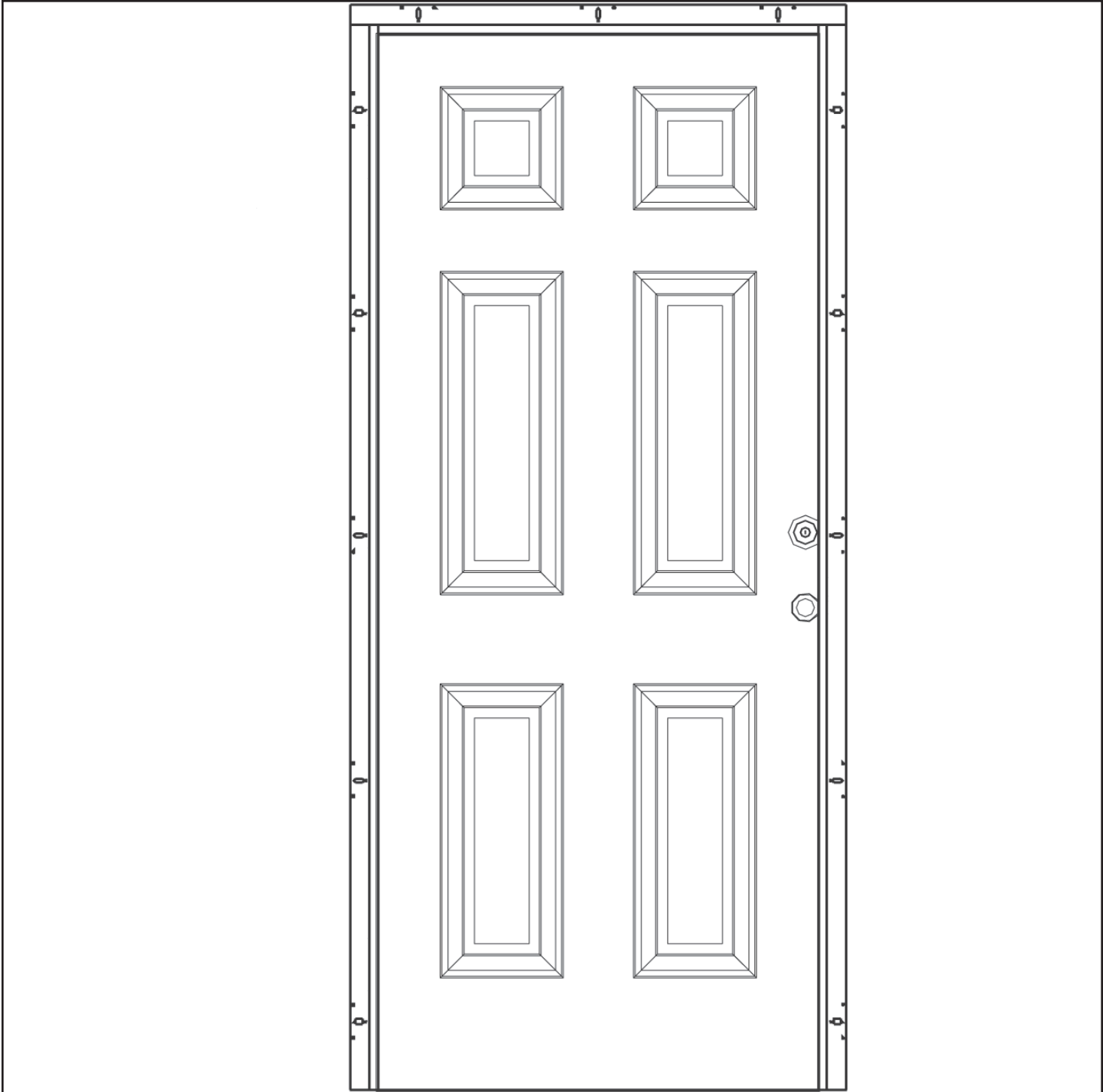

ACHIEVER

Pre-Hung Entry Door Systems

SINGLE DOOR INSTALLATION PROCEDURE – SERIES FD



1101 Technology Drive | Dothan, Alabama 36303
800.633.7553 | 334.794.9184 (fax)
www.dunbarton.com | sales@dunbarton.com

BEFORE YOU BEGIN

PLEASE FOLLOW ALL INSTRUCTIONS AND ALWAYS USE PROTECTIVE EYEWEAR WHEN INSTALLING A DOOR SYSTEM. PLEASE READ INSTRUCTIONS COMPLETELY.

Preparation of Opening

Verify that opening is plumb, square and level. Measure the Finished Opening Size (Figure 1); refer to chart below to insure proper fit of Achiever® unit.

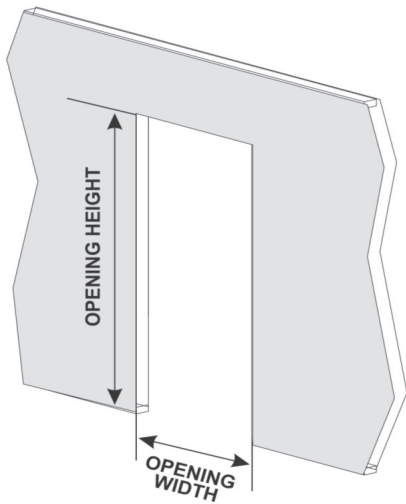

FIGURE 1

Finished Opening Sizes

Door Width	Opening Width	6'8" Opening Height
2'8"	33-1/4"	80-3/4" ADA 81-11/16" STANDARD
3'0"	37-1/4"	80-3/4" ADA 81-11/16" STANDARD

INSTALLATION OF ACHIEVER OUTSWING

Step 1

Remove door from packaging. Move to install area; assemble tools & materials

- Safety glasses
- Level
- Tape measure
- Phillips head screwdriver
- Weather Seal Putty or Silicone
- #8 x 1" minimum wood attachment screws

Step 2

Apply sealant

Apply weather seal putty or silicone to the mounting flange of the steel frame (Figure 2). Apply a bead of putty or silicone across bottom of threshold (Figure 2A).



FIGURE 2

Step 3



FIGURE 2A

Apply a line of putty / silicone across **underside** of threshold.

Install Door System in Opening

Grasp the frame on the sides, lift and tilt toward you (Figure 3). Move the door system into the opening, setting the threshold down first and then tilting the unit up into the opening. Push the door and frame towards the hinge side of the opening. Check hinge jamb to make sure it is plumb and level.



FIGURE 3

Step 4

Install Screws

Install four (4) #8 x 1" wood attachment screws, one in each corner and check for proper fit of the unit (Figures 4, 4A).



FIGURE 4A

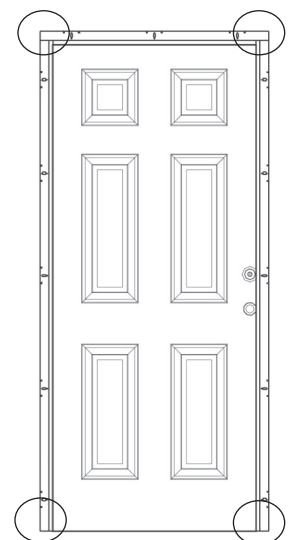

FIGURE 4

Step 5

Remove Prehang Material

Remove prehang bracket from door latch bore. Open door and remove margin spacing clips (Figure 5).

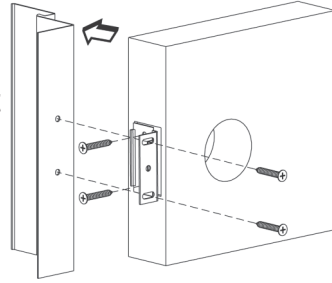

FIGURE 5

Step 6

Adjust Doors to Opening

Plumb hinge side using level and t-square; make any necessary adjustments to verify squareness/placement of the frame (Figure 6 and 6A). Install the balance of the #8 x 1" wood attachment screws into every hole.

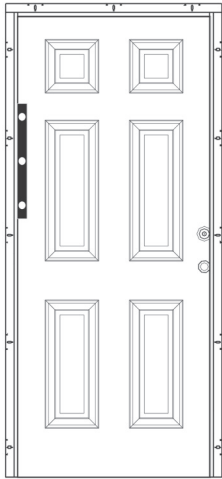

FIGURE 6



FIGURE 6A

Step 7

Optional Shims

Shim behind hinge if required (Figure 7A-7B). Install shims from interior.

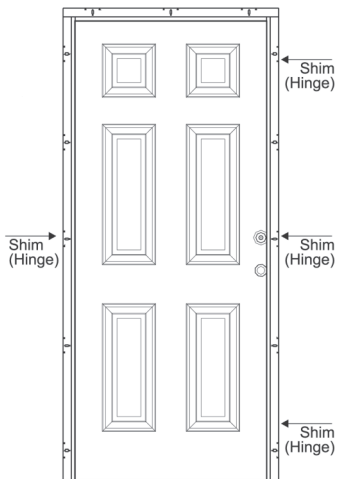

FIGURE 7A



FIGURE 7B

Step 8

Caulk Frame (as needed)

Caulk the frame where the header meets the uprights and where the threshold meets the upright (Figures 8 and 8A).

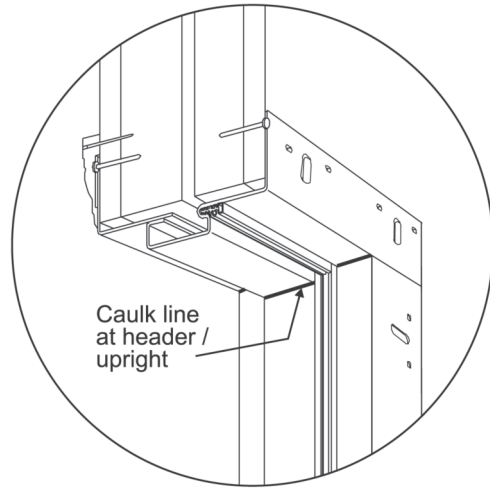

FIGURE 8



FIGURE 8A

Step 9

Anchor threshold

To anchor to floor, install #10 x 1" minimal length flat head screw (suitable for floor material) in countersunk holes of threshold. Use shims if necessary to prevent deflection of threshold ensuring it remains parallel to bottom of door.

WARRANTY

The Warranty for Steel Frames manufactured by ACHIEVER® PRODUCTS DIVISION is to the original consumer purchaser to be free from defects in material and workmanship for a period of one (1) year from the date of purchase.

This warranty is applicable only when the product(s) covered by it have been installed in accordance with the recommended written installation instructions of ACHIEVER® PRODUCTS DIVISION and with established building practices, have been accorded treatment which is considered good practice in the building industry regarding storage and maintenance, and have been subject only to normal use. Because ACHIEVER® PRODUCTS DIVISION cannot control the manner in which its products are handled after leaving its premises, this warranty does not apply to the finish or accessories of any product.

ANY AND ALL IMPLIED WARRANTIES HERETO ARE LIMITED TO ONE (1) YEAR FROM THE DATE OF PURCHASE.

Some states do not allow limitations on how long an implied warranty lasts, so the above limitations may not apply to you. In

the event the original consumer purchaser of any ACHIEVER® product believes that the frame or any parts thereof covered by this warranty are defective, a letter outlining the alleged defect should be sent postage prepaid to the following address:

ACHIEVER® PRODUCTS DIVISION
Division of the Dunbarton Corporation
P.O. Box 8577 Dothan, Alabama 36304-0577

Any ACHIEVER® Products Steel Frame, or any parts thereof covered by this warranty which, upon inspection by an authorized representative of ACHIEVER® PRODUCTS DIVISION, are found by said representative to be defective will be repaired, replace, or at the option of ACHIEVER® PRODUCTS DIVISION, the purchase price of the frame or part will be refunded and does not include labor, installation costs, finishing costs, or indirect or consequential damages of any nature. Some states do not allow the exclusion or limitation of incidental or consequential damages, so the above limitation or exclusion may not apply to you.

This warranty gives you specific legal rights, and you may also have other rights which vary from state to state.

**INSTALLATION QUESTIONS OR MISSING PARTS?
CALL US FIRST.**

**DO NOT RETURN THIS FRAME SYSTEM TO
THE STORE.**

Thank you for purchasing this Achiever® product. We take pride in the products we manufacture and are confident you will be pleased with your selection. However, sometimes a product may leave our factory in less than perfect condition. If you have questions or are missing component parts necessary to complete the installation, do not return the frame to the place of purchase. Give us a call first. More than likely, we can solve the problem without the hassle and expense of returning the frame to the store. **Call Customer Service: 1-800-633-7553 from 8:00 a.m. to 5:00 p.m. CST, Monday through Friday.**



1101 Technology Drive | Dothan, Alabama 36303
800.633.7553 | 334.794.9184 fax
www.dunbarton.com | sales@dunbarton.com